

TABLE 1

DASH NO.	SWITCH	LENS TYPE	ENGRAVING
SW43690	AS SHOWN	WL1563W	NONE
SW43690-001	AS SHOWN	WL1563W	FIG. 1
SW43690-002	AS SHOWN	WL1563W	FIG. 2
SW43690-003	AS SHOWN	WL1563W	FIG. 3
SW43690-101	NONE	WL1563W	FIG. 1
SW43690-102	NONE	WL1563W	FIG. 2
SW43690-103	NONE	WL1563W	FIG. 3

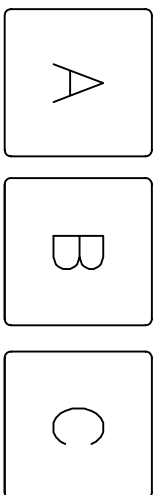
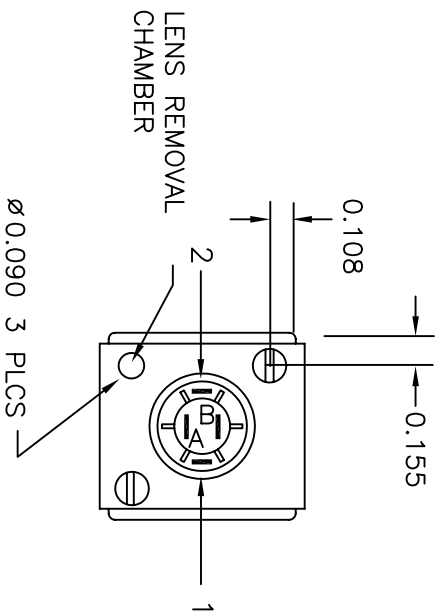
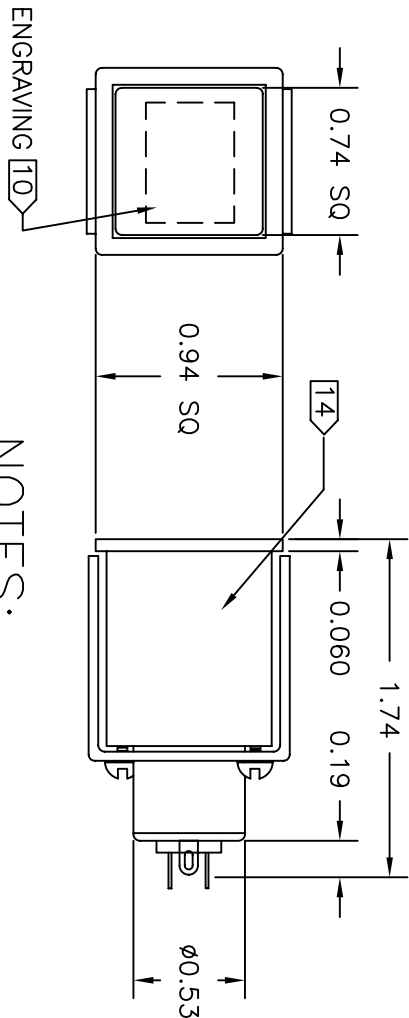

FIG.1

FIG.2

FIG.3

SEE CUBIC ARCG DWG. 9326-0103 REV C FOR LETTER LOCATIONS AND DIMENSIONS



NOTES:

1. RATINGS: 30 VDC OR 115 VAC. 2A RESISTIVE, 500ma INDUCTIVE.
2. OPERATING PRESSURE: 2 LBS ± 1 LB.
3. PLUNGER TRAVEL: 0.100 APPROX.
4. ACTUATIONS: 100,000.
5. CONTACTS: GOLD PLATED CONTACTS.
6. TERMINALS: STANDARD EMC SOLDER LUG.
7. SWITCH TYPE: 6SELHWA-W5328GP, 1PST, NO, MOMENTARY, ILLUMINATED PUSHBUTTON SWITCH
8. LENS: SEE TABLE 1.
9. MOUNTING: HARD MOUNT.
10. LENS ENGRAVING: SEE CUBIC ARCG DRAWING 9326-0103 REV B.
11. LAMP: D382, 14v, 80mA.
12. MOUNTING HOLE: 0.875 +0.010/-0.000 SQUARE.
13. CUSTOMER: CUBIC AUTOMATIC REVENUE COLLECTION GROUP.
14. SWITCH BEZEL MOLDED IN VALOX.

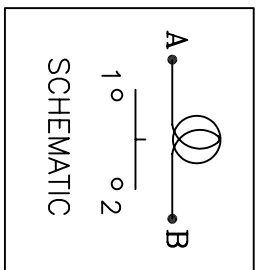

E	NOTE 3 TRAVEL WAS 0.187	17SEP97	TT
D	REMOVE BRaille DOTS CENTER A,B,C LETTERS ON LENS	13NOV95	TT
C	LENS WAS WL63W ADD BRaille DOTS, MODIFY LENS ENGR. MODIFY TABLE 1.	10AUG95	TT
B	MODIFY TERMINAL POSITIONS NOTE 7 WAS NON-ILLUMINATED	6/30/94	TT
A	SWITCH WAS 5428 ADD D382 LAMP	5-5-94	DAF
LT	REVISIONS	DATE	

ELECTRO-MECH COMPONENTS INC.

SOUTH EL MONTE, CALIFORNIA \* (818) 442-7180

PUSHBUTTON SWITCH

FSCM: 07150	SCALE FULL	DRAWN DAF
DIM. IN INCHES	TOL. .XX± 0.020 .XXX± 0.010	FILE SW43690

CHK'D	APVD
DATE 5-4-94	

SW43690